

Operating Instructions for the SCARE AWAY M-3 Cannon
Refer to Drawing D 71

THE SCARE AWAY SHOULD BE OPERATED OUTDOORS ONLY AND UNDER NO CIRCUMSTANCES IN AN ENCLOSED PLACE. ALWAYS WEAR EAR PROTECTION WHEN WITHIN 50 FEET OF SCARE AWAY.

1. After removing the SCARE AWAY from the shipping box, attach the barrel extension #54 (with the welded seam "down" so water will drain from the weep hole) to the barrel of the explosion chamber #83 and tighten the three bolts #56 with a wrench. These three bolts must be tight or explosion pressure will damage the bolt connections on the combustion chamber #83.
2. With a full tank of L.P. gas, open the valve and allow a small amount of L.P. gas to escape; close the valve at once.
3. Connect the pressure reducer valve to the L.P. gas tank with the bull nose connector #103 and tighten nut #107 with a wrench. Caution: Connector #103 and threads must be clean.
4. The frequency of firing is adjustable. The time between detonations can be adjusted from approximately 30 seconds to approximately 30 minutes by use of the needle valve on the left side of the SCARE AWAY frame. To increase the frequency, turn handle #129 counter-clockwise in the direction of the arrow on dial #139. To decrease the frequency turn the handle clockwise. Adjust the frequency to your requirements.
5. To start the SCARE AWAY, slowly open the valve of the L.P. gas tank. The SCARE AWAY will fire at the same frequency as previously set, without further adjustment.
6. To stop the SCARE AWAY, close the valve of the L.P. gas tank.
7. To start the SCARE AWAY again, open the valve of the L.P. gas tank. The SCARE AWAY will fire at the same frequency as previously set, without further adjustment.
8. The SCARE AWAY M-3 is equipped with a flint ignition system. Each flint will produce about 1,000 ignitions. To change the flint, remove the rear weather cover #82, and pull the flint holder #80 in a downward direction. Place the flint in the flint holder and release the holder. The flint will now be secure and the cannon will be ready to fire. The flint wheel will produce about 5,000 ignitions. To change the flint wheel, remove shaft #79. Both flints and flint wheels are available at our office.

Suggestions and Precautions

Always use ear protection.
Use only propane (L.P.) gas.
Use only the original pressure reducer valve.
No smoking or open flame near the SCARE AWAY.
Empty chemical or oil drums make good mounting platforms.
Change locations often. Change rate of fire often.

Questions? Here's how to contact us.

Reed-Joseph International Company
P.O. Box 894 or 800 Main Street
Greenville, Mississippi 38702
Telephone: 662-335-5822 * Facsimile: 662-335-8850
Toll Free: 800-647-5554 * Internet: www.reedjoseph.com

TROUBLE SHOOTER GUIDE

PROBLEM	CAUSE	REMEDY
The SCARE AWAY Model M-3, fully connected, fails to operate at all.	The L.P. gas cylinder valve is not open.	Open valve.
	The L.P. gas cylinder is empty.	Replace fuel.
	The needle valve(#123-140) is not open.	By turning needle valve lever in direction of arrow, frequency of detonations will increase.
	The needle valve (#123-140) cannot be opened.	Replace needle (#137) or replace complete needle valve.
Leaks	The pressure reducer valve (#111-127) is not attached to the L.P. gas cylinder tightly enough.	Tighten coupling nut (#107) with wrench.
	The hose (#148) from the pressure reducer valve to the needle valve, or the hose (#12) from the needle valve to the base of the mechanical assembly has been damaged.	Replace hose.
	Diaphragm (#121) in pressure reducer valve leaks.	Replace diaphragm or replace complete pressure reducer valve.
	Diaphragm (#64) in mechanical assembly leaks.	Replace diaphragm.
	Diaphragm (#11) in gas release valve leaks.	Replace diaphragm or replace complete gas release valve.
	Interior hose (#49,12) in gas release valve leaks.	Replace interior hose or replace complete gas release valve.
The SCARE AWAY Model M-3 operates, but there is no explosion	Ignition gives weak spark or no spark at all.	Check flint (# 72) for dryness.
		Check flint (#72) for wear.
		Check flint wheel (#78) for wear.
		Check flint wheel holder (#80) has flint properly in place.
		Check entire sparking assembly (#73-81) for damage. Replace where necessary.
The SCARE AWAY Model M-3 works, but gives dull explosion.	Wind is too strong and gas/air mixture is disturbed.	Place SCARE AWAY Model M-3 out of the wind or place muzzle down-wind.
	Barrell Extension (#54) or firing chamber (#83) contains debris	Remove barrell extension. If debris is found in barrell extension or firing chamber, remove debris.

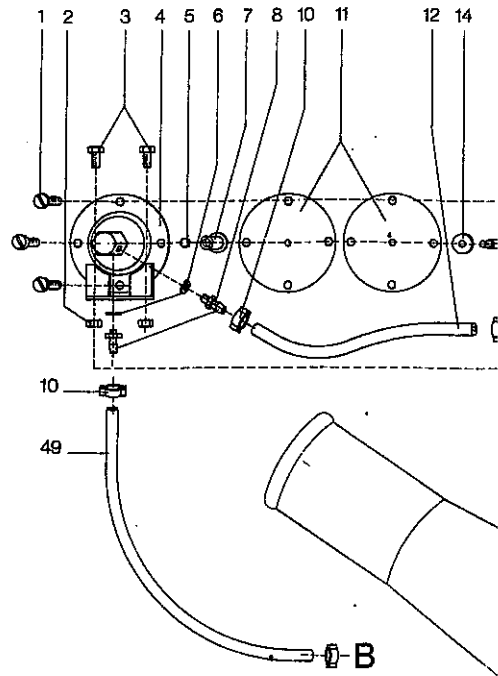

Z

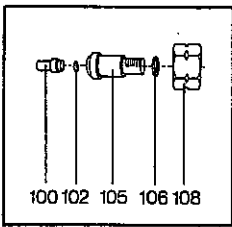

Y

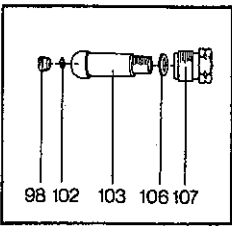

X

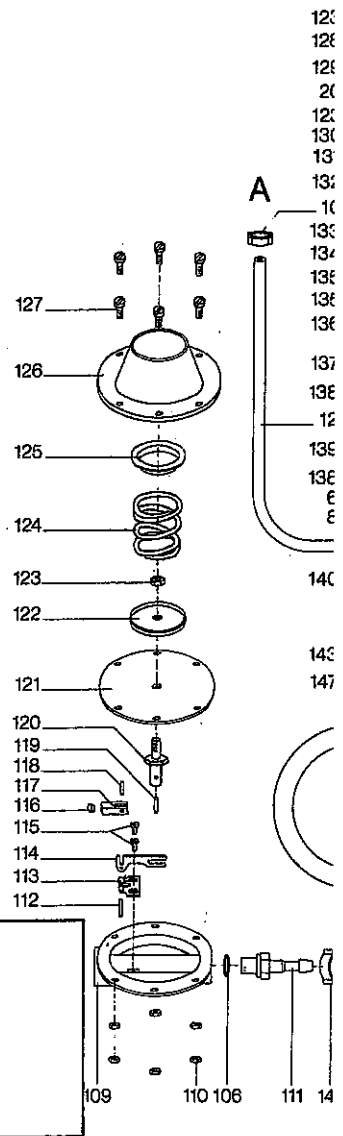
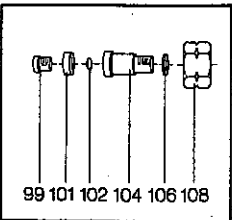

D71

